

PLAT OF SURVEY

Lots 1462 – 1475 Inclusive of Block 32 of Pell Lake Subdivision, Town 1 North, Range 18 East, Walworth County, Wisconsin.

Ordered by: Sidney Franke
P.O. Box 841
Lake Villa, IL 60046

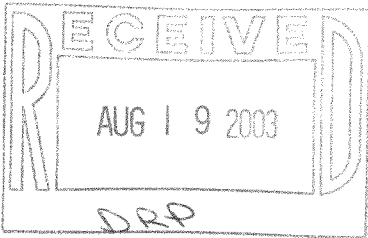

LEGAL DESCRIPTION FOR PARCEL 1

Part of Lot 1472 and all of Lots 1473 – 1475 of Block 32 of Pell Lake Subdivision, located in Town 1 North, Range 18 East, Walworth County, Wisconsin, described as follows; Commence at the Northwest Corner of said Block 32; thence S 2°30'E along the easterly line of Beech Road, 225.32 feet to a found iron pipe which marks the southwest corner of said Lot 1475; thence N 2°30'W along said road line 70.00 feet; thence N 87°29'37"E 140.20 feet; thence S 15°06'07"E 71.68 feet to a found iron pipe which marks the southeast corner of said Lot 1475; thence S 87°28'37"W along the southerly line of said Lot 155.84 feet to the point of beginning. Said parcel contains 10,229 square feet of land more or less.

LEGAL DESCRIPTION FOR PARCEL 2

Parts of Lots 1468 and 1472 and all of Lots 1469 – 1471 of Block 32 of Pell Lake Subdivision, located in Town 1 North, Range 18 East, Walworth County, Wisconsin, described as follows; Commence at the Northwest Corner of said Block 32; thence S 2°30'E along the easterly line of Beech Road, 79.32 feet to the point of beginning; thence N 87°30'52"E 123.22 feet; thence S 15°06'07"E 77.83 feet, thence S 87°29'37"W 140.20 feet to a point in the easterly line of Beech Road; thence N 2°30'W 76.00 feet along said road line to the point of beginning. Said parcel contains 10,007 square feet of land more or less.

LEGAL DESCRIPTION FOR PARCEL 3

Part of Lot 1468 and all of Lots 1462 – 1467 of Block 32 of Pell Lake Subdivision, located in Town 1 North, Range 18 East, Walworth County, Wisconsin, described as follows; Begin at the Northwest Corner of said Block 32; thence N 75°12'E along the southerly line of Grove Road 102.94 feet to the northeast corner of said Lot 1462 and a found iron pipe; thence S 15°06'07"E 103.79 feet; thence S 87°30'52"W 123.22 feet to a point in the easterly line of Beech Road; thence N 2°30'W 79.32 feet to the point of beginning. Said parcel contains 10,359 square feet of land more or less.

BASIS FOR BEARINGS

THE WEST LINE OF BLOCK 32
WAS ASSUMED TO BEAR N 2°30'W
AS SHOWN ON PLAT OF PELL LAKE
SUBDIVISION

LEGEND

- FOUND IRON PIPE
- FOUND IRON ROD
- ⊗ FOUND BRASS CAPPED MONUMENT
- FOUND CONCRETE MONUMENT
- + CHISEL CUT IN CONCRETE
- SET IRON ROD, 24" LONG, WEIGHING 1.5 LBS./LINEAL FT., 3/4" DIA.
- SET IRON ROD, 30" LONG, WEIGHING 4.5 LBS./LINEAL FT., 1-11/16" DIA.

(x x x) RECORDED AS DIMENSION|

— — — — — EXISTING FENCE

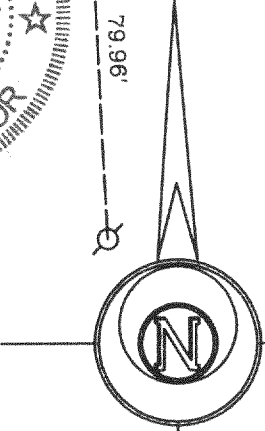

"I hereby certify that the above described property has been surveyed by me or under my direction and that the above map is a true representation thereof and shows the size and location of the property, its exterior boundaries, the location of all visible structures and dimensions of all principal buildings thereon, boundary fences, apparent easements, roadways and visible encroachments, if any."

"This survey is made for the use of the present owners of the property, and also those who purchase, mortgage, or guarantee the title thereto within one year from the date hereof."

Kenneth B. Abernathy, Jr.

KENNETH B. ABERNATHY, JR. S-1594
WISCONSIN REGISTERED LAND SURVEYOR,

DATED MAY 23, 2003 Job No. 03.406

